

CAR PARK 2021/2

New-build Car Park Emser Therme, Bad Ems

The Emser Therme offers its guests relaxation at the highest level, with 6,600 m² of spa grounds, sauna park, wellness gallery, fitness panorama and a restaurant. For a long time, the adjacent residential areas complained about the overflow of parking due to the high volume of visitors. Now that a hotel is also to be added, a practicable solution was required.

On a plot of land that is very challenging in every respect, a new multi-storey car park with 278 parking spaces was planned and put into operation in June 2021.

It is a single- Each level of the car park is reached using a curved ramp fronting the street. The construction method, is the tried-and-tested AMP vaulted-ceiling system, in which, despite a floor height of only 2.65 m, a generous head height of 2.50 m and even under beams a head clearance of 2.35 m could still be implemented.

As usual with AMP garages, traffic moves in one-way traffic. The parking spaces are 2.50 m wide and placed at a user-friendly angle.



Southwest Elevation (Photo: Levin Liebmann)

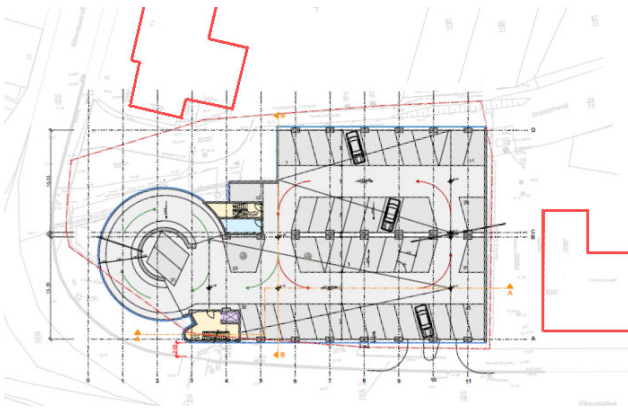

Typical Floor Plan



Telephone:

Fax:

Mail

Internet:

AMP Parking Holding GmbH The Parking Experts

Thujaweg 1

D - 76149 Karlsruhe

+49 721 / 98574 - 0

+49 721 / 98574 - 99

info@amp-parking.com

www.amp-parking.com



Southeast Elevation (Foto: Levin Liebmann)



Parking level (Photo Levin Liebmann)

Client:

Emser Therme GmbH

Planning services AMP

General planning

General Contractor:

Deurer GmbH & Co. KG

Car Park Information:

Number of spaces:	277
Parking space width:	2,50 m
Total gross floor area:	9.535 m ²
Building cost net:	7.300.000 €
Opening:	June
2021	